

WARRANTY

(Effective January 1, 2007)

HIX will automatically register the equipment on the date it was shipped to you or your distributor. If the equipment was not purchased directly from HIX, but through a distributor (either domestic or foreign), please keep a copy of their sales invoice showing the serial number and date it was sold/shipped to you with this warranty. In this case, we will use the distributor's invoice date as the beginning warranty date. **STAPLE A COPY OF YOUR RECEIPT TO THIS WARRANTY** and keep in a safe place to provide verification of your warranty should a problem occur. Thank you.

Please fill in the following information and attach a copy of your receipt for your records.

Date Purchased: _____ From: _____
Model #: _____ Serial #: _____

This warranty applies to equipment manufactured by the HIX Corporation (HIX), Pittsburg, Kansas, U.S.A. HIX warrants to the original purchaser, its Conveyor Dryers, Heat Transfer Presses, Mug Presses, Mug Glazer, Retensionable Screen Frames, Textile Printers, Spot Heaters, and Exposure Units against defects in workmanship and material, except for wear and tear for a period of "One Year" from the date of purchase. HIX warrants its Accessories, Reten Spines/Hardware/Tool Kit, and Shuttle for a period of 90 days from the date of purchase. DoughXpress and Thermalrol products are covered under separate warranty.

In the event of a defect, HIX, at its option, will repair, replace or substitute the defective item at no cost during this period subject to the limitations of insurance and shipping costs stated below.

In the case of heat transfer presses (except the Mug Press, Hobby Lite), HIX warrants the heat casting for the "Life" of the machine for the original purchaser. If a part becomes obsolete at the time for repair, and/or cannot be reasonably substituted for, HIX will credit, at half the then current list price or last recorded price, only that part toward a new machine or any product HIX offers. This credit offer shall be the sole responsibility of the HIX Corporation in the event of an obsolete part.

This warranty does not cover belts, pads, mug wraps, mug press liners, canvas, rubber blankets, bulbs, glass, PTFE or finish, rod ends, turn buckles on printers, or mug press or damages due to accident, misuse/abuse, alterations or damage due to neglect, shipping or lack of proper lubrication or maintenance. HIX shall not be responsible for repairs or alterations made by any person without the prior written authorization by HIX. This warranty is the sole and exclusive warranty of HIX and no person, agent, distributor, or dealer of HIX is authorized to change, amend or modify the terms set forth herein, in whole or in part.

In the case of a problem with the equipment identified herein, HIX Corporation should be contacted during regular business hours to discuss the problem and verify an existing warranty. HIX personnel will assist the customer to correct any problems which can be corrected through operation or maintenance instructions, simple mechanical adjustments, or replacement of parts. In the event the problem cannot be corrected by phone, and upon the issuance of a return authorization by HIX, the equipment shall be returned to HIX or an authorized service representative. All insurance and shipment/freight costs are solely the responsibility of the customer, and not that of HIX, and HIX shall not be responsible for improper handling or damage in transit. HIX offers a reconditioning service and a core exchange/credit policy on some models. HIX customer service personnel may be contacted for complete return authorization and reconditioning information.

This expressed warranty is given in lieu of any and all other warranties, whether expressed or implied, including but not limited to those of merchantability and fitness for a particular purpose, and constitutes the only warranty made by HIX Corporation.

In no event shall HIX's liability for breach of warranty extend beyond the obligation to repair or replace the nonconforming goods. HIX shall not be liable for any other damages, either incidental or consequential, or the action as brought in contract, negligence or otherwise.

This warranty gives you specific legal rights and you may also have other rights which vary from state to state.

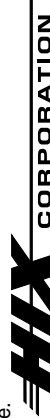

Manufacturers of the Finest Quality Textile and Graphics Screen Printing and Heat Transfer Equipment

1201 E. 27th Terrace • Pittsburg, KS 66762 • U.S.A.
Web site: www.hixcorp.com • Phone: (800) 835-0606
E-Mail: customerservice@hixcorp.com • Fax: (866) 561-0894
E-Mail: sales@hixcorp.com • Fax: (866) 563-4600

HT-400D/HT-600D

15"x15" / 16"x20" Heat Transfer Machines

OWNER'S MANUAL



HT-600D



For Customer Service, Call **1-800-835-0606**
ext. 209, ext. 211, ext. 220, ext.221 or
Visit www.hixcorp.com

CONTENTS

Receiving and Shipping	2
Temperature & Instructions	3
Pressure	3
Transfer Application	4
Troubleshooting	5
Fuse Replacement	6
Relay Bypass	7
Maintenance	8
Parts Identification	9-10
Warranty	12

BEFORE warranty repair you MUST get Prior Authorization:

RECEIVING AND INSTALLATION

UNPACKING

Remember to save all packing materials - including box, liner and board. You may need these for shipping your machine or if a repair is necessary in the future.

INSPECTION

Inspect your machine for hidden shipping damage. Contact the delivery company immediately, should you find damage.

SHIPPING OR RETURNS

NOTE: Save all of your shipping/packing materials.
DO NOT RISK COSTLY SHIPPING DAMAGE!
SHIP ONLY IN ORIGINAL BOX.

1. Fasten machine to plywood shipping base with bolts provided.
2. Tie or tape handle securely to base.
3. Place in original box, and put side liner and top liner in place. Fold in flaps and seal the box.

(Additional bottom boards, box and liners may be obtained from your supplier for a nominal cost.)

INSTALLATION

1. Remove plywood shipping base.

CAUTION: Handle must be tied to base before moving or shipping.

2. Plug the machine into the correct grounded electrical outlet. The HT-600 requires a 20 amp receptacle.

WARNING: When using an extension cord, use 12 or 14 ga.-3 conductor. Maximum length, 25' (7.62 m).

PARTS IDENTIFICATION

#	DESCRIPTION	Part #	Qty.
31.	Assembly Doghouse		1
30.	Cordset		1
29.	Cord Grip	13250	1
28.	Fuse Holder	57118	1
27.	Fuse		1
26.	Timer		1
25.	Dohouse Back		1
24.	EMI Filter		1
46.	Pin Handle Link	42129	1
47.	Screw #14x1-1/4 Tap PHPH	59816	2
48.	Assembly Handle Grip & Dowel	26856	1

WARNING: For continued protection against risk of fire, replace with the following fuses only: 120 Volt Units - Buss MDA-15; 220 Volt Units - Buss MDA-10.

PARTS IDENTIFICATION

#	DESCRIPTION	Part #	Qty.
1.	Assembly HT400/600 Handle	10499	1
2.	Assembly Link/Pin Main Arm	42110	1
3.	Assembly Main Arm	42404	1
4.	Link Rocker	10502	2
5.	Pin Rocker Link	42137	1
6.	Nut 1/2" Push	20214	12
7.	Knob Plastic	25143	1
8.	Nut Jam 1/2-20	25151	3
9.	Block 2-1/2" Adj. Threaded	25526	1
10.	Pin Rocker Link Pivot	41384	1
11.	Assembly Top Adjusting Rod	25208	1
12.	Relay	1
23.	Terminal Board	72231	1
22.	Screw #8x1/2 Tap-B PPHP	21482	8
21.	Bolt Lower Platen	2
20.	Washer Spring	12378	12
19.	Pin Main Arm Link	41384	1
18.	Spring #105	49122	2
17.	Nut 1/4-20 Hex	14548	4
16.	Bolt 1/4-20x1-3/4	10710	2
15.	Switch	1
14.	Nut 1/2-20 Nylloc	89078	1
13.	Assembly Frame	41384	1
35.	Washer 3/8" Hard	86504	4
36.	Spacer Heatshield	41384	4
37.	Casting 1620 Lower	82768	1
38.	Pad 1/2" 1620	50542	1
39.	Casting Upper Heated	1
40.	Heatshield	41384	1
41.	Thermostat	1
42.	Thermometer	40345	1
43.	Assembly Thermostat Cover	22640	1
44.	Thermostat Knob	14217	1
45.	Spacer Haysite	41384	2
34.	Switch Rocker	1
33.	Lamp Red	1
32.	Decal Overlay	09970	1

OPERATION

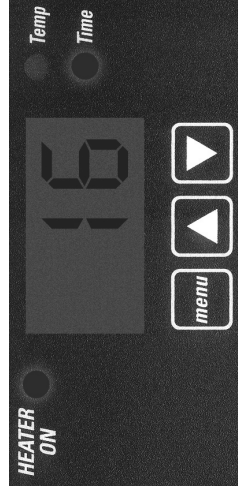

TEMPERATURE & TIME INSTRUCTIONS

1. Turn on the machine by pushing the on/off switch.
2. To change or set the temperature, press the menu button on the digital control. The light next to "TEMP" will light. Press the up ▲, or down ▼, button to your desired setting.
3. To change or set the time, press the menu button on the digital control. The light next to "TIME" will light. Press the up ▲, or down ▼, button to your desired setting.
4. When you have your desired settings **press the menu button a third time to lock in your settings** otherwise the previous settings will still be used.
5. Wait for the machine to reach your preset temperature by monitoring the display temperature until it matches the set temperature.

PRESSURE

1. The pressure control knob, located on the top of the machine, should be set so that the heat head will lock down firmly.
2. Pressure is reduced by turning knob (with machine open) **counter-clockwise** and increased by turning it **clockwise**.

NOTE: Adjustments may be required from one garment to another and will vary to achieve the desired result.

CAUTION: Excessive pressure can cause structural damage, voiding the machine warranty!

OPERATION

TRANSFER APPLICATION

1. Set the temperature, time, and pressure to the desired settings as instructed on page 3. **Always** consult your specific transfer recommendations. Typical settings are: Cold Peel - 350°F (177°C), 15 seconds and Hot Split - 375°F (190°C), 10-12 seconds.
2. Align garment on the lower platen and smooth out the wrinkles.
NOTE: Wrinkles may be removed by bringing heated platen in contact with the garment before the transfer is positioned.
3. Position the transfer and close the machine.
4. Pull operating handle down locking the machine closed. After the designated time has elapsed, open the machine.
5. Continuously peel the paper off the transfer (away from your garment). **NOTE:** Do not fold the transfer back on itself. Successful transfer work depends on the correct balance of time, temperature and pressure. The type and thickness of the material and the kind of transfer being used will determine what settings are necessary.

If a hot peel/split transfer is being applied, immediately peel the paper after the machine has opened. **DO NOT** allow the transfer to cool. If a cold peel transfer is being applied, rub the transfer with an eraser or cloth and allow to cool for 5-10 seconds before removing the release paper.

Specific application instructions are enclosed with each transfer.

MAINTENANCE

Exploded View

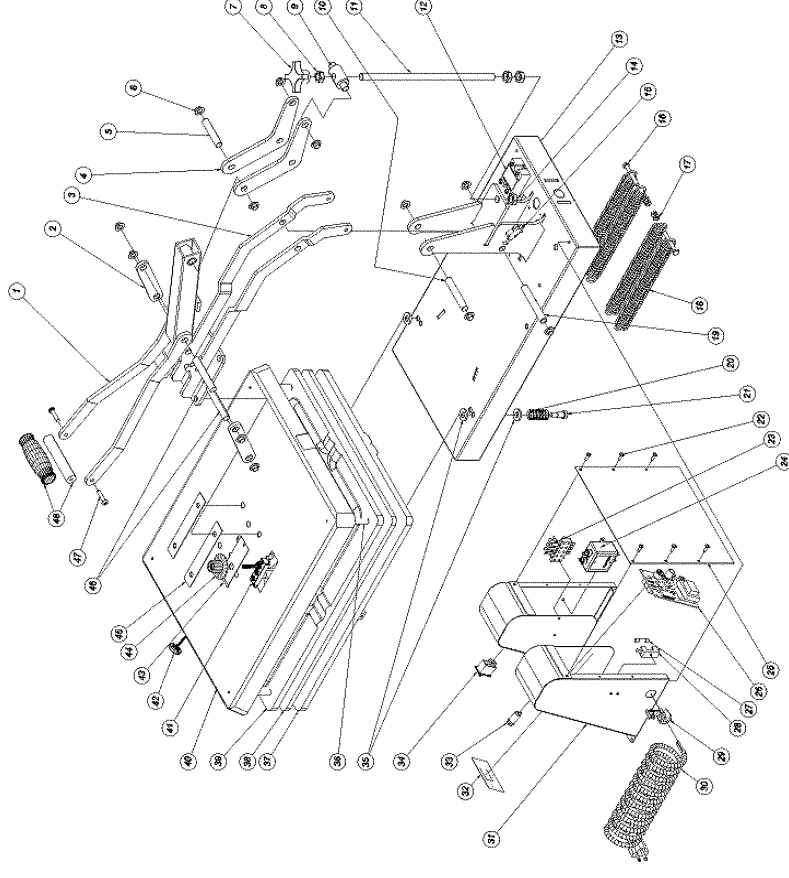

MAINTENANCE

Lubrication

Your press requires lubrication every 6 months. Using 3-in-1 oil (available from your hardware store), add one to two drops of oil at all moving parts.

NOTE: Unplug the machine before lubricating.

Cleaning The Heat Platen

You may clean the heat platen with steel wool, scrubbing aluminum sponge, or fine wire brush.

TROUBLESHOOTING

WARNING: Before making repairs, be sure on/off switch is off and machine is unplugged!

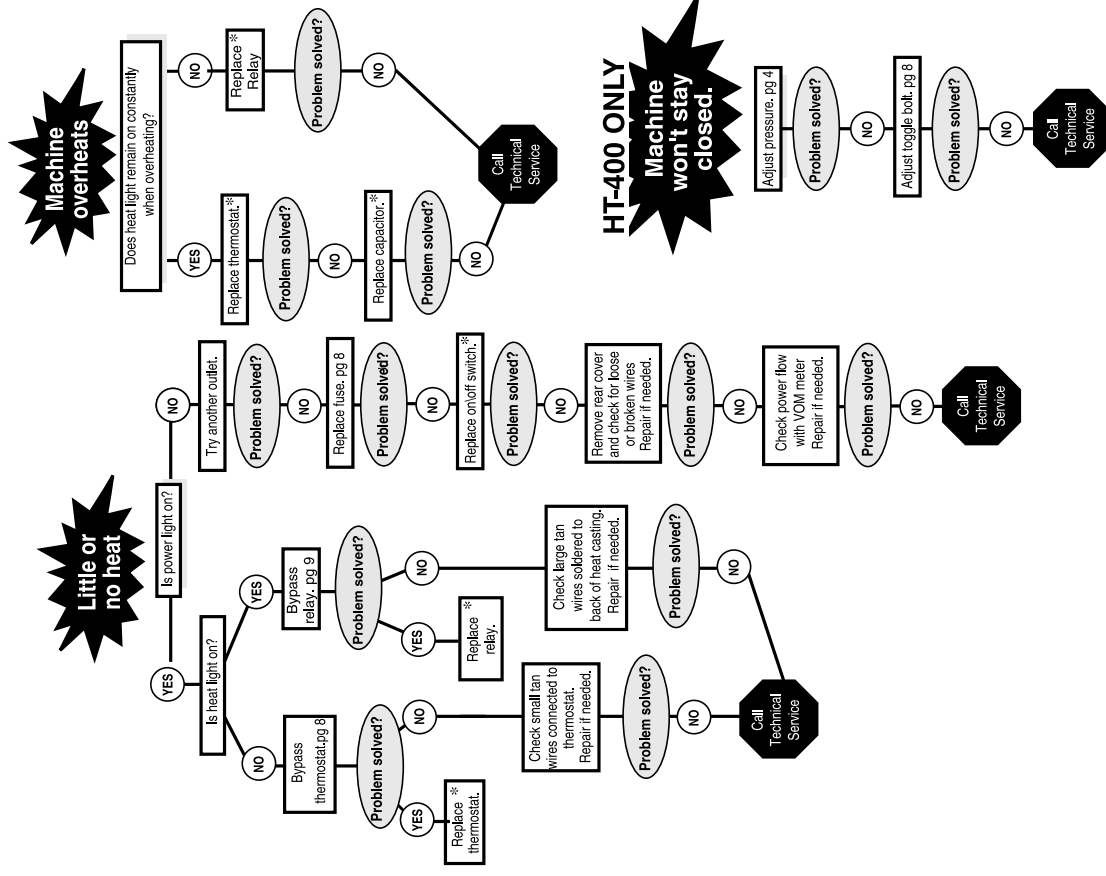

*Customer Service Tech Sheets are available for this step. Visit www.hixcorp.com to print or call 620-231-8568 and we will send you one. Parts ordering is available on-line.

REPAIRS

FUSE REPLACEMENT

WARNING: Before making repairs, be sure on/off switch is off and machine is unplugged!

1. Remove back cover of the machine and locate internal fuse holder on inside of the machine.
2. Remove blown fuse. Replace with the proper fuse.
HT-400: 120V=MDA-15; 220V=MDA-8
HT-600: 120V=MDA-15; 220V=MDA-10
3. Replace back cover of machine.

REPAIRS

RELAY BYPASS

WARNING: Before making repairs, be sure on/off switch is off and machine is unplugged!

1. Remove the back cover of the machine.
2. Remove wire #26 from terminal #2 on relay.
3. Loosen terminal #1 on relay and replace wire #26 along with wire #12 under terminal #1.
4. Tighten the connection.
5. Plug machine in and turn the power switch on.

NOTE: Replace the relay if the machine starts heating. This is a test only. Do not operate machine with relay bypassed.